



ARPAN VILASH

ARPAN COLONY, TETARTOLI TALAB,
NEAR RIMS, RANCHI

A HOME THAT YOU DESERVE.



ABOUT US



Truth, honesty and integrity. The pillars on which we
built. fortresses of happiness, pride and love
The building blocks for your lifelong relationship.

“ARPAN VILASH is a mantra of exclusivity, serenity and calm. These exquisite homes are open, perfectly planned fluid spaces designed to enhance the lives of those who inhabit them. The architectural concept re-envisioned urban living as a balanced serene sanctuary in the heart of the city's most vibrant and prestigious neighborhoods. The Project is situated at PRIME LOCATION of Ranchi City Arpan Colony, Tetartoli Talab, Behind Bariyatu Thana, Near Rims, Ranchi. It is a study in luxurious living for Ranchi People. With limited 2 towers of happiness, ARPAN VILASH gives you an unmatched piece of privacy with detailed luxurious add-ons like party area, Guest Parking and beautiful landscaped gardens with Sufficient Open Space. This is CNT free Project.

Come home to opulence, now called the ARPAN VILASH

ARPAN VILASH is a project of 108 flats, make a choice from elegantly created 3 BHK homes. A quality home with premium specifications in a pollution free environment is the dream of every family. Take the first step to moving into a fine home. The harmonious interaction of space, materials and form creates a soothing and relaxed environment. You will feel completely at home in a place that embraces you in its serenity, one that whispers with an unmistakable imprint of grace and timelessness, Glassy floors and minimal furnishing create a tranquil, Zen like atmosphere, The natural Glossy surfaces provide a soothing welcome for you and your guests.



MASTER PLAN

LADIES AND GENTLEMEN,
MAY WE PRESENT 3 BHK CUSTOMIZABLE RESIDENCES FOR
'QUALITY CONSCIOUS' PERSONALITIES



ARPAN VILASH

MAGNIFICENT HIGH-RISE EDIFICE WITH DESIGNER ELEVATION
BEST IN CLASS HEALTH, LIFESTYLE & RECREATIONAL FEATURE
THOUGHTFULLY PLANNED & DESIGNED



BIRD VIEW



BLOCK A (3D VIEW)

G+9



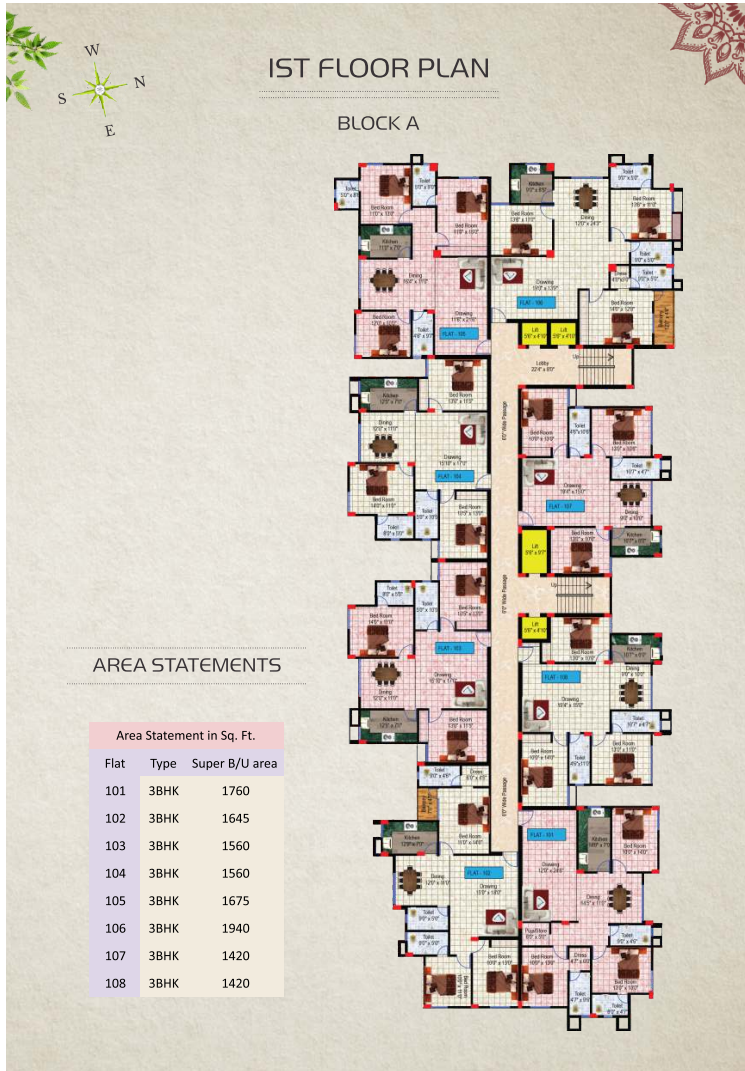

IST FLOOR PLAN

BLOCK A

AREA STATEMENTS

Area Statement in Sq. Ft.		
Flat	Type	Super B/U area
101	3BHK	1760
102	3BHK	1645
103	3BHK	1560
104	3BHK	1560
105	3BHK	1675
106	3BHK	1940
107	3BHK	1420
108	3BHK	1420

TYPICAL 2ND-7TH FLOOR PLAN

BLOCK A



AREA STATEMENTS

Area Statement in Sq. Ft.		
Flat	Type	Super B/U area
101A	3BHK	1985
102A	3BHK	1820
103A	3BHK	1645
104A	3BHK	1645
105A	3BHK	1860
106A	3BHK	2040
107A	3BHK	1485
108A	3BHK	1555

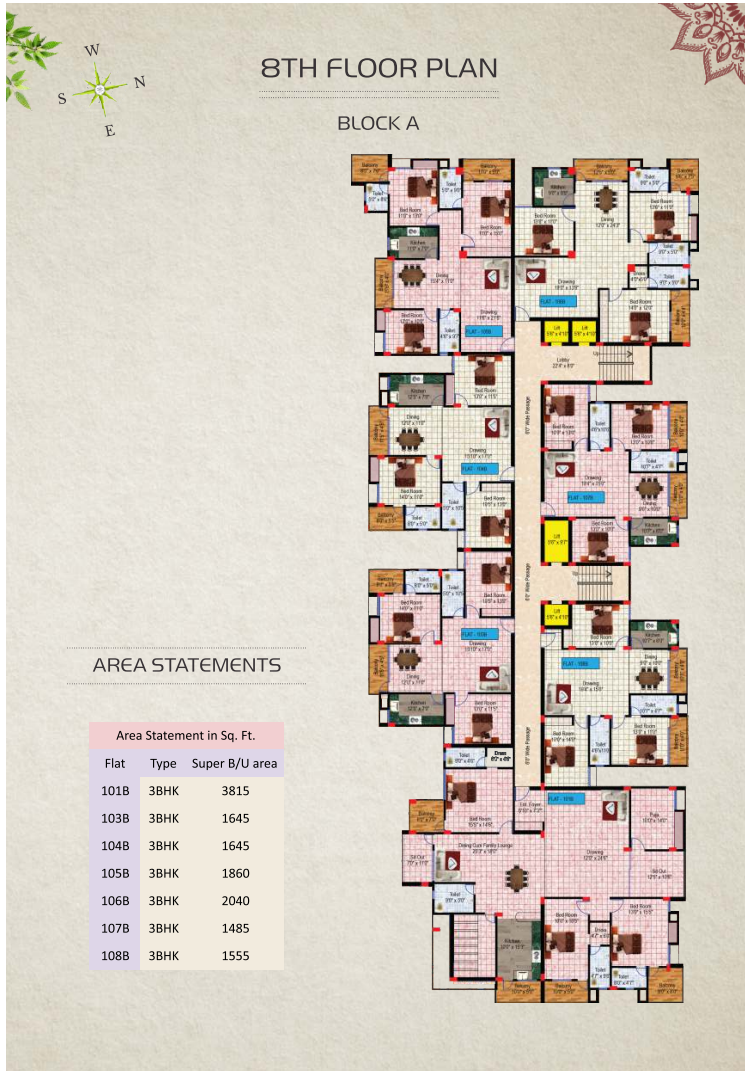

8TH FLOOR PLAN

BLOCK A

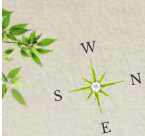

AREA STATEMENTS

Area Statement in Sq. Ft.		
Flat	Type	Super B/U area
101B	3BHK	3815
103B	3BHK	1645
104B	3BHK	1645
105B	3BHK	1860
106B	3BHK	2040
107B	3BHK	1485
108B	3BHK	1555

9TH FLOOR PLAN

BLOCK A



AREA STATEMENTS

Area Statement in Sq. Ft.		
Flat	Type	Super B/U area
101C	3BHK	3695
103C	3BHK	1645
108C	3BHK	1555











BLOCK B (3D VIEW)

G+9



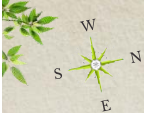

1ST FLOOR PLAN
BLOCK B

AREA STATEMENTS

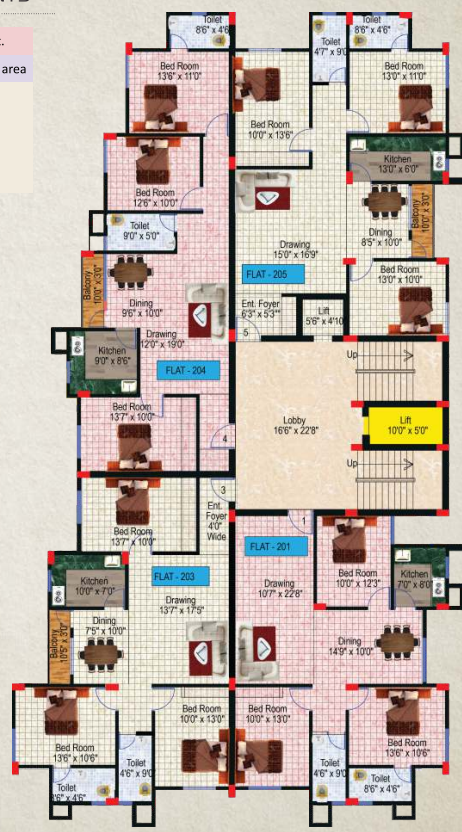
Area Statement in Sq. Ft.		
Flat	Type	Super B/U area
201	3BHK	1410
203	3BHK	1480
204	3BHK	1505
205	3BHK	1560

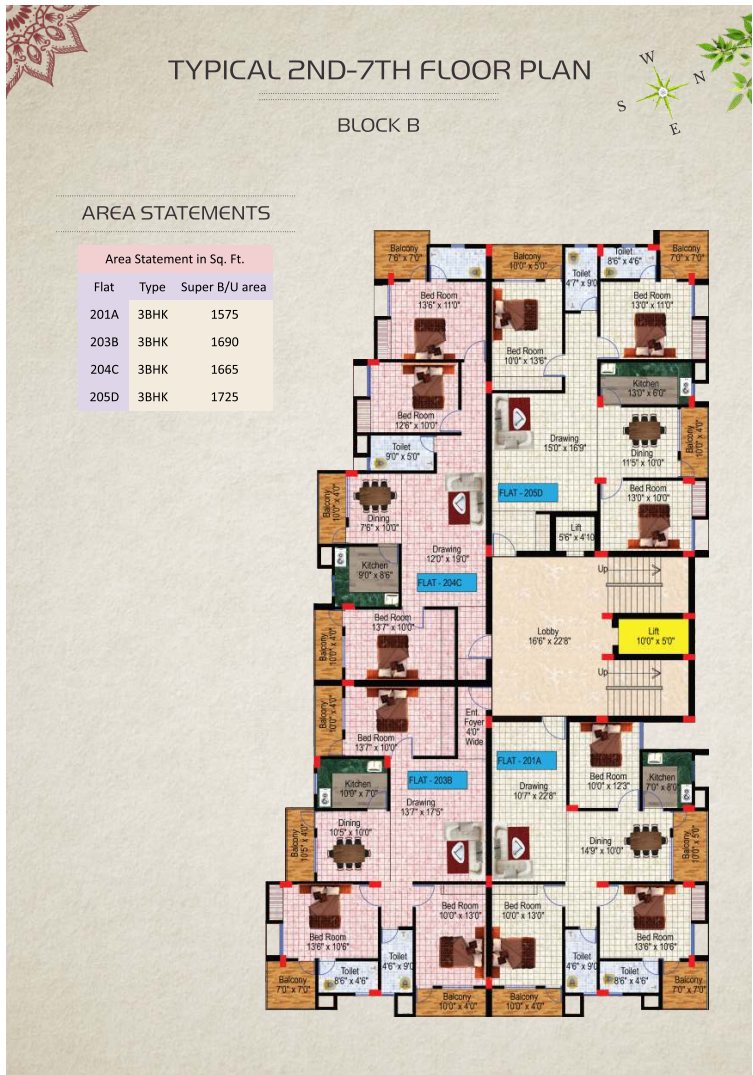



TYPICAL 8TH-9TH FLOOR PLAN
 BLOCK B

AREA STATEMENTS

Area Statement in Sq. Ft.		
Flat	Type	Super B/U area
206E	3BHK	3269
207F	3BHK	3385







ISOMETRIC VIEW

BLOCK B

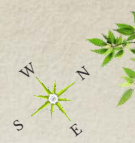

Flat 206E

Type : 3 bhk
Super built up Area : 3269 sft



Flat 207F

Type : 3 bhk
Super built up Area : 3385 sft

SPECIFICATIONS

Structure	: R.C.C. framed structure as per design & Specification of structure consultant.
Chaukhat	: Wooden Door frame (Chaukhat) .
Door	: Decorative Main door and Rest will be flush door of standard make.
Window	: 3 Tracks UPVC sliding windows.
Kitchen	: (a) Flooring - Vitrified Tiles (b) Working Platform - Granite © Dado - 24" height glazed tiles (d) Sink -Stainless Steel Sink
Flooring	: (a) Flooring - Vitrified (b) Bathroom Wall - 7' glazed Tiles
Lift	: Six passengers manual lift (ISI).
Stair Landing & Steps	: Marble.
Electrical	: Concealed copper wiring Modular switches and Fittings of reputed brand (ISI make).
T.V./Tel. Plug Point	: One TV/Tel. plug point provided in drawing room & M.B.R.
A.C. Points	: One power plug point in each bedroom.
Internal Wall finish	: All internal wall shall be finished with Smooth plaster of paris, a coat of primer.
External Wall Finish	: External wall finish with elevation design from weather coat paint.
C.P.Fitting	: Chromium plated fittings of reputed brand.
Sanitary Ware	: White sanitary with wall hung W.C. and diverter system.
Generator Set	: 500 W power back-up to each flat & 24 hours power supply for Lift.

FACILITIES

- Temple
- Jogging Track
- Children Park
- Peaceful Residential Surrounding.
- Ample Visitor's Car Parking.
- 62% Open Space.
- Beautiful Entrance foyer/lobby in each block.
- Equipped With Fire Fighting Equipments.
- 24 Hours Power Backup For Common Areas.
- Loan / Emi Facility Available.
- Reputed Schools, Court, Hospital, Hotels, Atm & Bank Near Project.
- 24 Hour Security With CCTV Camera And Guard.
- Technically Designed For Natural Sunlight & Fresh Air Ventilation
- Boom Barrier with Car tag facility at Entrance.
- Gym & Yoga Meditation Centre.

LOCATION MAP



A PROJECT AT PROMINENT LOCATION

Developer :



OFFICE : GE, AMBIKA ENCLAVE, SHIV BAGAN, MAKEY ROAD, NEAR RAJ BHAWAN, RANCHI.

OFFICE : 98/B1, EMRITY KUNJ, HARIHAR SINGH ROAD, MORABADI, RANCHI.

☎ : 8521456165, 9905705709

email : arpanmega6565@gmail.com

This brochure is not legal document. It only describes the conceptual plan to convey the intent and the purpose of ARPAN MEGA STRUCTURE.

OUR ARCHITECT :- GRIDS CONSULTANTS, 2ND FLOOR,
ROSHPA TOWER, MAIN ROAD, RANCHI.
M-9431104040, 9835156276